

1

2

3

4

5

6

A

A

B

B

C

C

D

D

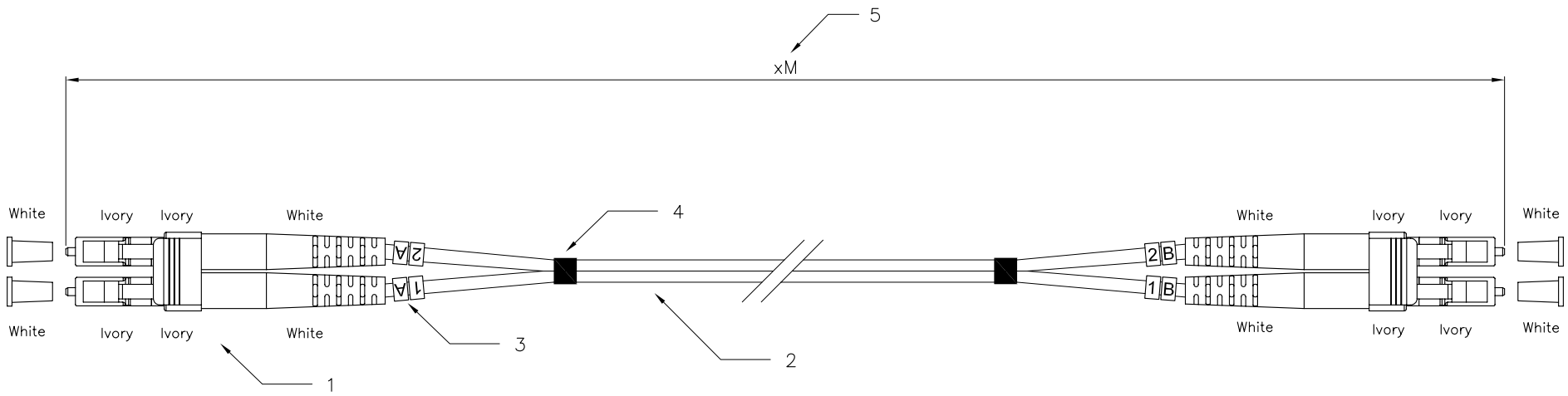

Specification:

- 1. Connector Type : LC Multimode
- 2. Cable Type :
 2-1 Zipcord Cable, $\phi 3.0\text{mm}$, 62.5/125um Multimode.
 2-2 Cable Jacket : Orange Color, LSZH Material.
- 3. Cable Marker
- 4. Shrink Tube
- 5. Length : xM

Performance:

- a. Insertion Loss : $< 0.5 \text{ dB}$
- b. Fiber Extention : $-0.05\mu\text{m} < H < +0.05\mu\text{m}$
- c. Ferrule End-face Radius : $7 < R < 25\text{mm}$
- d. Apex Offset : $< 50\mu\text{m}$
- e. Increase in insertion loss after 500 mating : 0.2 dB Max
- f. Operation Temperature : $-20^\circ \text{ to } +70^\circ$
- g. Storage Temperature : $-40^\circ \text{ to } +80^\circ$

GENERAL TOLERANCE OF DIMENSIONS X.XXX ±0.005 X.XX ±0.05 X.X ±0.1	DRAWING	04.NOV.2009	ZCY	ITEM NO.: AFCJC093131XXXX
	CHECK	04.NOV.2009	DAY	
	APPROVAL	04.NOV.2009	YTY	
	SCALE	1/1 (A4)	UNIT	mm
DRAWING NO.		AFCJC093131XXXX(SA1)		SHEET 1 OF 1
DRAWING CLASSIFICATION		S		

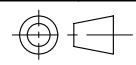

1

2

0

3

4

10cm

5

6