

Specification:

1. Connector Type : SC/UPC Singlemode
2. Cable Type :
 - 2-1 Zipcord Cable, $\phi 2.0\text{mm}$, 9/125 μm Singlemode.
 - 2-2 Calbe Jacket : Yellow Color, LSZH Material.
3. Cable Marker
4. Shrink Tube
5. Length : xM

Performance:

- a. Insertion Loss : $< 0.3 \text{ dB}$
- b. Return Loss : $> 50 \text{ dB}$
- c. Fiber Extention : $-0.05\mu\text{m} < H < +0.05\mu\text{m}$
- d. Ferrule End-face Radius : $8 < R < 25\text{mm}$
- e. Apex Offset : $< 50\mu\text{m}$
- f. Increase in insertion loss after 500 mating : 0.2 dB Max
- g. Operation Temperature : -20°C to $+70^{\circ}\text{C}$
- h. Storage Temperature : -40°C to $+80^{\circ}\text{C}$

GENERAL TOLERANCE OF DIMENSIONS x.xxx ±0.005 x.xx ±0.05 x.x ±0.1	DRAWING	05.NOV.2009	ZCY	ITEM NO.: AFCIA061717XXXX
	CHECK	05.NOV.2009	DAY	
	APPROVAL	05.NOV.2009	YTY	
	DATE	NAME		
SCALE	1/1 (A4)	UNIT	mm	DES.: SC to SC Duplex patch cord
DRAWING NO.		AFCIA061717XXXX(SA1)		
DRAWING CLASSIFICATION		S	SHEET	1 OF 1

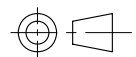

10cm